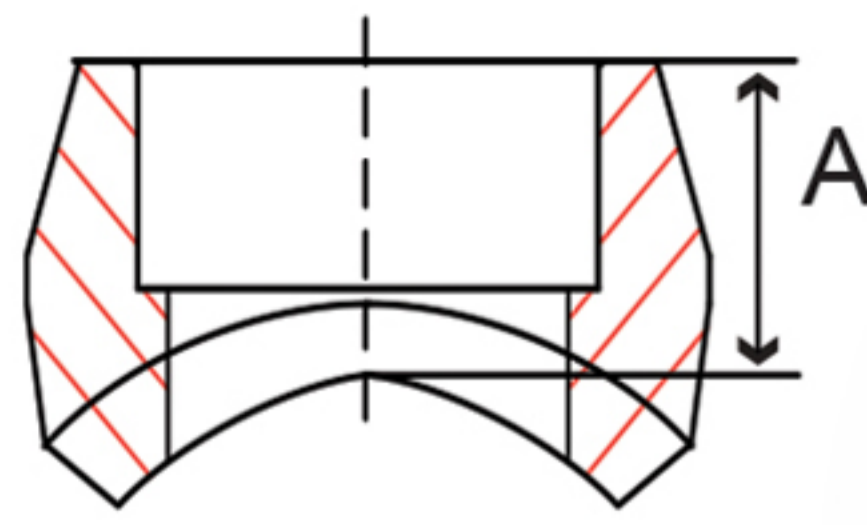

Fig. 43S03 – Socket Weld Outlet



Size IN	Part Number	A IN	Master	Weight LB
1/2 x 3/4 thru 36	43SO3004006360	1.01	150	0.2
3/4 x 1 thru 1-1/4	43SO3006010012	1.13	100	0.2
3/4 x 1-1/2 thru 36	43SO3006014360	1.13	100	0.2
1 x 1-1/4 thru 2-1/2	43SO3010012024	1.38	50	0.5
1 x 3 thru 36	43SO3010030360	1.38	50	0.5
1-1/4 x 1-1/2	43SO3012010004	1.38	40	0.8
1-1/4 x 2 thru 3-1/2	43SO3012020034	1.38	40	0.8
1-1/4 x 4 thru 36	43SO3012040360	1.38	40	0.8
1-1/2 x 2 thru 2-1/2	43SO3014020024	1.44	25	1.0
1-1/2 x 3 thru 5	43SO3014030050	1.44	25	1.0
1-1/2 x 6 thru 36	43SO3014060360	1.44	25	1.0
2 x 2-1/2 thru 3-1/2	43SO3020024034	1.56	10	1.7
2 x 4 thru 6	43SO3020040060	1.56	15	1.7
2 x 8 thru 36	43SO3020080360	1.56	15	1.7
2-1/2 x 3 thru 3-1/2	43SO3024030034	1.62	10	2.5
2-1/2 x 4 thru 5	43SO3024040050	1.62	10	2.5
2-1/2 x 6 thru 8	43SO3024060080	1.62	10	2.5
2-1/2 x 10 thru 36	43SO3024100360	1.62	10	2.5
3 x 3-1/2 thru 4	43SO3030034040	1.81	6	4.0
3 x 5 thru 6	43SO3030050060	1.81	6	4.0
3 x 8 thru 14	43SO3030080140	1.81	6	4.0
3 x 16 thru 36	43SO3030160360	1.81	6	4.0
4 x 5 thru 6	43SO3040050060	1.94	1	6.3
4 x 8 thru 10	43SO3040080100	1.94	1	6.3
4 x 12 thru 20	43SO3040120200	1.94	1	6.3
4 x 22 thru 36	43SO3040220360	1.94	1	6.3